

## Stainless Steel-Locking pins

with L-Handle, lockable

### SPECIFICATION

#### Type

- Type L: with L-handle

#### Identification

- **SC**: with key (keyed alike)
- **SU**: with key (keyed differently)

Plunger pin / Pawl  
Stainless Steel AISI 303 **NI**

L-Handle  
Plastic (Polyamide PA)

- black
- temperature resistant up to 80 °C

Lock mechanism  
Zinc die casting / Stainless Steel

Key (two pieces)  
Steel, nickel plated



### INFORMATION

Stainless Steel-Locking pins GN 314 with L-Handle and key are used for quick fixing, connecting and locking of various jig and fixture systems without the need for tools. Turning the key 180° moves the pawl at the front end of the pin to engage the axial locking of the inserted pin. After locking, unauthorized removal is no longer possible. The key can be removed in both end positions. The key can be removed in the end positions. Locks with coding SC are keyed alike, allowing each lock to be operated with the same key. Locks with coding SU have different locks with 68 different lock versions and correspondingly numbered keys. The technical appendix contains the load capacities for the double-sided shearing resistance (breaking strength).

- Range of lock pins (see page 868)

### ACCESSORY

- Ball chains GN 111 (see page 904)
- Stainless Steel-Ball chains GN 111.5 (see page 905)
- Retaining cables GN 111.2 (see page 906)
- Spiral retaining cables GN 111.4 (see page 908)

### TECHNICAL INFORMATION

- ISO-Fundamental Tolerances (see page A21)
- Stainless Steel characteristics (see page A26)

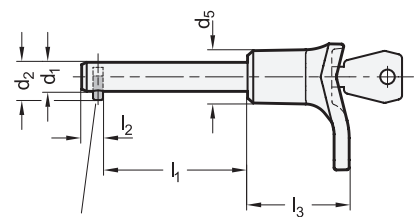
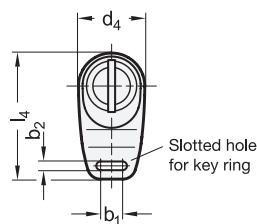

#### Application example

